

Dimensions

NH-AN (High-load type/standard, square type)

NH-BN (Super-high-load type/long, square type)

(1) Reference number for assembly

NH	30	1200	AN	C	2		P5	3
SERIES NAME	SIZE	RAIL LENGTH (MM)	BALL SLIDE SHAPE CODE (refer to Fig 2 on page 4)	MATERIAL/SURFACE TREATMENT CODE (refer to Table 16 on page 8) C: Special high carbon steel (NSK standard) S: Stainless steel	NUMBER OF BALL SLIDES PER RAIL	DESIGN SERIAL NUMBER (Added to the reference number)	ACCURACY CODE (refer to page 5 and 6)	PRELOAD CODE (refer to page 6) 0: Z0 1: Z1 3: Z3 T: ZT Z: ZZ H: ZH

(2) Reference number for interchangeable type

Ball slide

NAH	30	AN	S	Z	-K
INTERCHANGEABLE BALL SLIDE SERIES CODE NAH: NH Series Interchangeable Ball Slide	SIZE	BALL SLIDE SHAPE CODE (refer to Fig 2 on page 4)	MATERIAL CODE No code: Special high carbon steel (NSK standard) S: Stainless steel	PRELOAD CODE No code: Fine clearance Z: Slight preload H: Medium preload	OPTION CODE -K: Equipped with NSK K1™ -K2: Two K1™ Lubrication Units -D: Double Seals -P: Protector Plate

Rail

N1H	30	1200	S	Z
INTERCHANGEABLE RAIL SERIES CODE N1H: NH Series Interchangeable Rail	SIZE	RAIL LENGTH (MM)	MATERIAL CODE No code: Special high carbon steel (NSK standard) S: Stainless steel	PRELOAD CODE Z: Slight preload

Model No.	Assembly			Ball slide											Width W ₁	Height H ₁
	Height H	E	W ₂	Width W	Length L	Mounting hole			L ₁	K	T	Grease fitting				
						B	J	M×Pitch ¹⁾				Hole size	T ₁	N		
NH15AN NH15BN	28	4.6	9.5	34	55 74	26	26	M4×0.7×6	39 58	23.4	8	∅3	8.5	3.3	15	15
NH20AN NH20BN	30	5	12	44	69.8 91.8	32	36 50	M5×0.8×6	50 72	25	12	M6×0.75	5	11	20	18
NH25AN NH25BN	40	7	12.5	48	79 107	35	35 50	M6×1×9	58 86	33	12	M6×0.75	10	11	23	22
NH30AN NH30BN	45	9	16	60	85.6 124.6	40	40 60	M8×1.25×10	59 98	36	14	M6×0.75	10	11	28	26
NH35AN NH35BN	55	9.5	18	70	109 143	50	50 72	M8×1.25×12	80 114	45.5	15	M6×0.75	15	11	34	29
NH45AN NH45BN	70	14	20.5	86	139 171	60	60 80	M10×1.5×17	105 137	56	17	Rc1/8	20	13	45	38
NH55AN NH55BN	80	15	23.5	100	163 201	75	75 95	M12×1.75×18	126 164	65	18	Rc1/8	21	13	53	44
NH65AN NH65BN	90	16	31.5	126	193 253	76	70 120	M16×2×20	147 207	74	23	Rc1/8	19	13	63	53

Notes: 1) External appearance of stainless steel ball slides differs from those of carbon steel ball slides.

Assembly (Preloaded assembly, interchangeable type)

Front view of AN and BN types

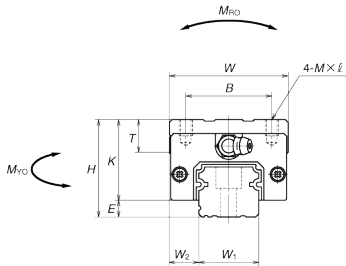

Side view of AN type

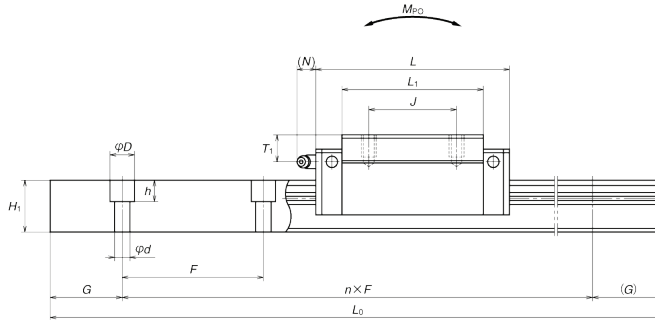

Side view of BN type

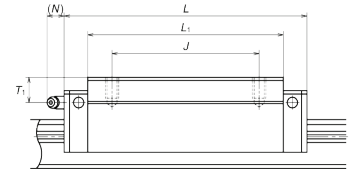

Ball slide of interchangeable type

AN and BN types

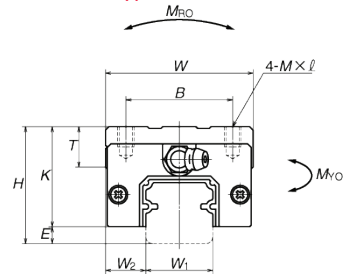

AN type

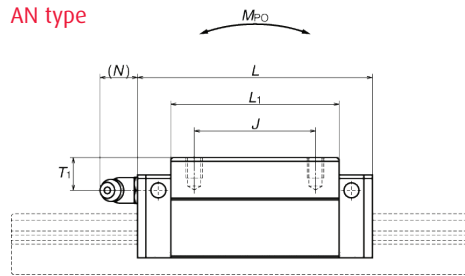

BN type

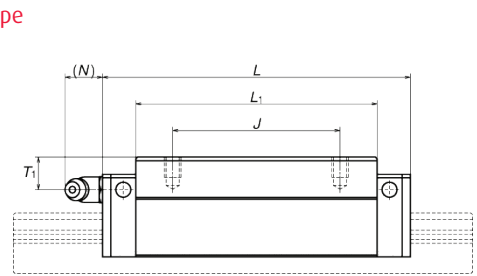

Rail of interchangeable type

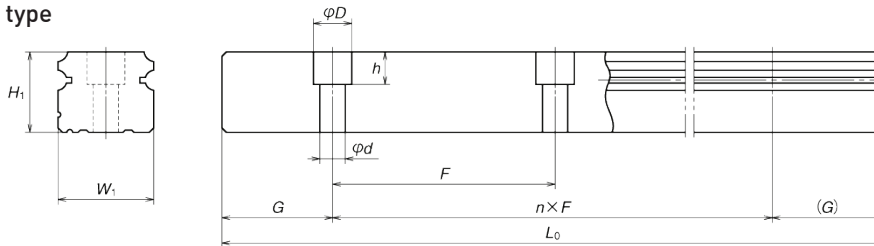

Unit: mm

Rail				Basic load rating								Weight	
Pitch F	Mounting bolt hole d x D x h	G (reference)	Max. length L _{0max} () for stainless	2) Dynamic		Static C ₀ (N)	M _{RO}	Static moment (N·m)				Ball slide (kg)	Rail (kg/m)
				[50km] C ₅₀ (N)	[100km] C ₁₀₀ (N)			M _{PO}		M _{YO}			
						(One slide)	(Two slides)	(One slide)	(Two slides)				
60	4.5x7.5x5.3	20	2 980 (1 800)	14 200 18 100	11 300 14 400	20 700 32 000	108 166	94.5 216	575 1 150	79.5 181	480 965	0.18 0.26	1.6
60	6x9.5x8.5	20	3 960 (3 500)	23 700 30 000	18 800 24 000	32 500 50 500	219 340	185 420	1 140 2 230	155 355	955 1 870	0.33 0.48	2.6
60	7x11x9	20	3 960 (3 500)	33 500 45 500	26 800 36 500	46 000 71 000	360 555	320 725	1 840 3 700	267 610	1 540 3 100	0.55 0.82	3.6
80	9x14x12	20	4 000 (3 500)	41 000 61 000	32 500 48 500	51 500 91 500	490 870	350 1 030	2 290 5 600	292 865	1 920 4 700	0.77 1.3	5.2
80	9x14x12	20	4 000	62 500 81 000	49 500 64 500	80 500 117 000	950 1 380	755 1 530	4 500 8 350	630 1 280	3 800 7 000	1.5 2.1	7.2
105	14x20x17	22.5	3 990	107 000 131 000	84 500 104 000	140 000 187 000	2 140 2 860	1 740 3 000	9 750 15 600	1 460 2 520	8 150 13 100	3.0 3.9	12.3
120	16x23x20	30	3 960	158 000 193 000	125 000 153 000	198 000 264 000	3 600 4 850	3 000 5 150	16 300 26 300	2 510 4 350	13 700 22 100	4.7 6.1	16.9
150	18x26x22	35	3 900	239 000 310 000	190 000 246 000	281 000 410 000	6 150 8 950	4 950 10 100	27 900 51 500	4 150 8 450	23 400 43 500	7.7 10.8	24.3

2) The basic load rating comply with the ISO standard. (ISO14728-1 and ISO14728-2)
C₅₀: the basic dynamic load rating for 50 km rating fatigue life, C₁₀₀: the basic dynamic load rating for 100 km rating fatigue life