



FAG

F520-B-L

Flanged housing

Numer materiałowy Schaeffler:
0384387980000

Flanged housing for various bearing types,
with conical bore and clamping sleeve,
continuous shaft

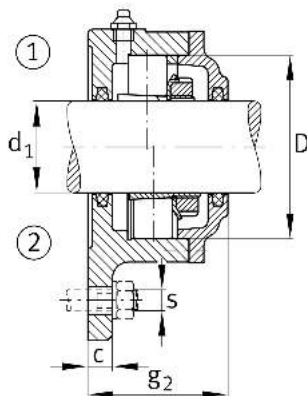
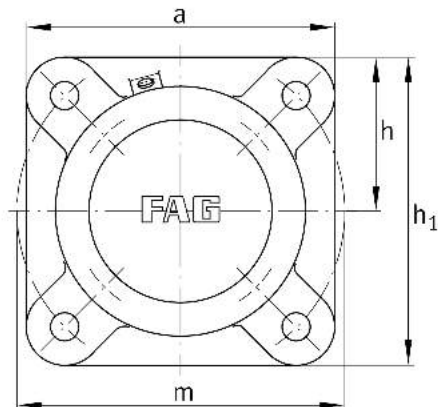

Main Dimensions & Performance Data

| | | |
|-------|---------|---------------------------|
| d_1 | 90 mm | Shaft diameter |
| a | 250 mm | Flange width |
| h_1 | 250 mm | height flange |
| g_2 | 127 mm | total width with cover |
| | 4 | number of fastening holes |
| | 17,9 kg | Masa |

Dimensions

| | | |
|-------|--------|------------------------------------|
| | M10x1 | connection thread lubrication |
| c | 30 mm | thickness of flange |
| D | 180 mm | outside diameter bearing |
| g_4 | 29 mm | distance flange to bearing seat |
| h | 125 mm | distance shaft axis |
| m | 280 mm | pitch circle diameter fixing holes |
| s | M20 | size of fixing screws |