

Standard Runner Blocks, Steel version

# Runner Block SLH

**Runner block SLH**  
**R1824 ... 10**  
**Slimline, long, high**  
**(Sizes 25 to 55)**

**Size 65:**  
**Runner block SLS**  
**1824 ... 10**  
**Slimline, long, standard height**

**Further runner block versions**

- with aluminum end caps
- for oil and grease lubrication from above
- for central oil lubrication systems
- for wall mounting

See the relevant sections for part numbers.

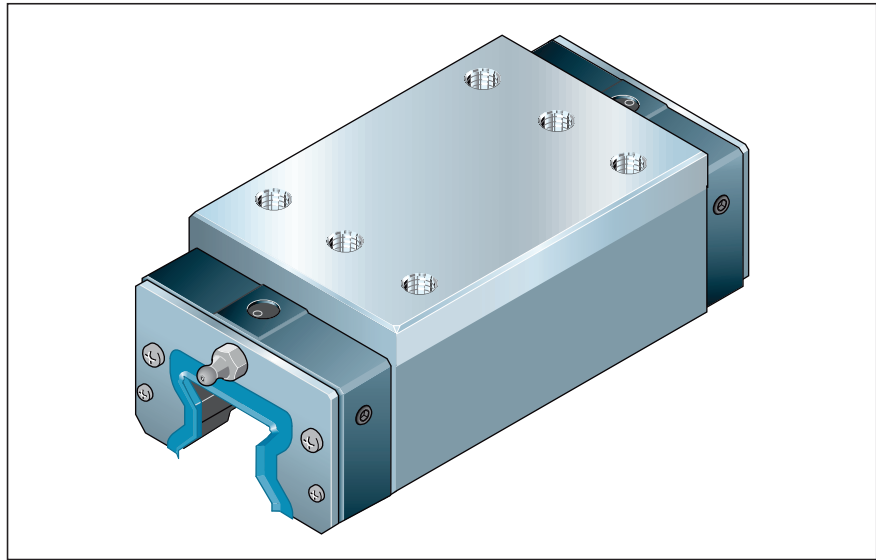

For corrosion-resistant runner blocks, Resist CR, matte silver hard chrome plated, see section on "Standard Runner Blocks, Resist CR".

**Recommended preload and accuracy class combinations**

- For preload class C2: H and P
  - For preload class C3: P and SP
- Preference should be given to runner blocks with preload C2.  
 Runner blocks with preload C1 are available on request. Part number: R1824 .1. 10

**Preload classes**

- C1 = preload 3% C  
(on request)
- C2 = preload 8% C
- C3 = preload 13% C

Size	Accuracy class	Part numbers for preload class	
		C2	C3
25	H	R1824 223 10	-
	P	R1824 222 10	R1824 232 10
	SP	R1824 221 10	R1824 231 10
	UP	R1824 229 10	R1824 239 10
35	H	R1824 323 10	-
	P	<b>R1824 322 10</b>	R1824 332 10
	SP	R1824 321 10	R1824 331 10
	UP	R1824 329 10	R1824 339 10
45	H	R1824 423 10	-
	P	<b>R1824 422 10</b>	R1824 432 10
	SP	R1824 421 10	R1824 431 10
	UP	R1824 429 10	R1824 439 10
55	H	R1824 523 10	-
	P	<b>R1824 522 10</b>	R1824 532 10
	SP	R1824 521 10	R1824 531 10
	UP	R1824 529 10	R1824 539 10
65	H	R1824 623 10	-
	P	R1824 622 10	R1824 632 10
	SP	R1824 621 10	R1824 631 10
	UP	R1824 629 10	R1824 639 10

**Note on dynamic load capacities and moments (see table)**

The dynamic load capacities and moments are based on 100,000 m travel. However, a travel of just 50,000 m is often taken as a basis.

If this is the case, for comparison purposes: Multiply values **C**, **M<sub>t</sub>** and **M<sub>L</sub>** from the table by 1.23.

Size	Load capacities (N)		Moment loads (Nm)			
	C	C <sub>0</sub>	M <sub>t</sub>	M <sub>10</sub>	M <sub>L</sub>	M <sub>Lo</sub>
25	33 300	70 000	432	908	420	900
35	69 700	149 300	1 375	2 953	1 135	2 430
45	119 200	256 600	2 941	6 331	2 520	5 430
55	165 000	345 300	4 837	10 122	4 030	8 440
65	265 500	525 600	9 410	18 630	7 960	15 760

**Standard runner block SLH R1824 ... 10**

**a)** For O-ring  
 Size 25: dia. 5 · 1.5 (mm)  
 Sizes 35 to 65: dia. 7 · 1.5 (mm)  
 Open lube bore as required. Send for instructions.  
 For new constructions, use runner blocks for lubrication from above.

**b)** Recommended location for pin holes (dimensions E<sub>4</sub>, see "Mounting Instructions", section on "Locating Pins").  
 Due to manufacturing reasons, there may be rough-drilled holes at the recommended positions. These can be bored open.

**c)** Lube nipple, thread M6 – 8 deep:  
 can be fitted on all sides (end face only on size 25).  
 Other lube fittings will have different dimensions.  
 For more details on lube fittings, see the "Accessories" section.

**d)** Due to manufacturing reasons, guide rails in accuracy class H may not have a slot on the base.

Size	Dimensions (mm)															
	A	A <sub>1</sub>	A <sub>2</sub>	A <sub>3</sub>	B	B <sub>1</sub>	B <sub>2</sub>	B <sub>3</sub>	d <sub>8</sub>	d <sub>8.2</sub>	E <sub>1</sub>	E <sub>2</sub>	E <sub>8</sub>	E <sub>8.2</sub>	E <sub>9</sub>	E <sub>9.2</sub>
25	48	24	23	12.5	109.0	81.5	111.0	115	6	5	35	50	33.4	40.22	12.40	25.40
35	70	35	34	18.0	138.0	103.6	140.0	145	6	5	50	72	50.3	56.60	20.10	36.10
45	86	43	45	20.5	172.5	134.0	176.5	183	8	6	60	80	62.9	69.55	26.75	46.50
55	100	50	53	23.5	205.5	162.1	209.5	216	10	6	75	95	74.2	81.60	28.95	50.75
65	126	63	63	31.5	254.0	194.0	258.5	264	8	8	76	120	35.0	106.00	9.30	55.00

Size	Dimensions (mm)															Weight kg
	H	H <sub>1</sub>	H <sub>2</sub> <sup>1)</sup>	H <sub>2</sub> <sup>2)</sup>	K <sub>1</sub>	K <sub>2</sub>	N <sub>3</sub>	N <sub>5</sub>	N <sub>6</sub> <sup>±0.5</sup>	S <sub>2</sub>	S <sub>5</sub>	S <sub>9</sub> <sup>3)</sup>	T <sub>2</sub> <sup>4)</sup>	V <sub>1</sub>		
25	40	34	23.60	23.40	20.60	–	9	9.5	14.3	M6	7	M3-5deep	30.0	7.5	0.9	
35	55	48	31.10	30.80	22.55	24.4	13	14.0	19.4	M8	9	M3-5deep	40.0	8.0	2.0	
45	70	61	39.10	38.80	33.70	36.6	18	18.0	22.4	M10	14	M4-7deep	52.5	10.0	4.2	
55	80	68	47.85	47.55	41.25	44.4	19	19.0	28.7	M12	16	M5-8deep	60.0	12.0	6.2	
65	90	76	58.15	57.85	48.80	52.0	21	9.3	36.5	M16	18	M4-7deep	75.0	15.0	12.0	

1) Dimension H<sub>2</sub> with cover strip  
 2) Dimension H<sub>2</sub> without cover strip

3) Thread for attachments  
 4) Dimension T<sub>2</sub> = hole spacing in the guide rail